

POTTING



PROCESS SOLUTIONS
YOU CAN COUNT ON

iCoat-3P SERIES

INLINE METERING AND MIXING MACHINE FOR POTTING APPLICATIONS

Features & Benefits

- Dispensing of single-component and multi-component materials
- Adjustable mixing ratio controlled by material preparation system
- Processing low viscosity to paste-like reactive resins
- 3 Axis system for potting applications
- Easy to operate and serviceopening

Product Description

iCoat-3P Inline metering and mixing machine for potting application with track chain type in and out of the board, upper production and lower reflow. SMEMA interface and three-axis positioning are integrated of the machine. The PC software can be used to set the parameters and teach the program.

With the compact mixing and potting machine with material preparation system and potting valve for processing liquid and paste-like reactive resins, the process will be realized in a precise and reliable way.

The equipment has an operator-friendly control system and can be easily integrated in an automation process. Due to the high degree of automation your productivity will increase and the quality will be ensured.



HV-01 High-pressure Valve for RTV



SDV-20 Two-Component Static Mixing Valve

ANDA Technologies USA, Inc.
info@anda.us
+1 510 270 8648
47639 Lakeview Boulevard, Fremont, CA 94538, USA



Specifications :

System Specifications

iCoat-3P
 Inline Metering and Mixing Machine for Potting
 Application

Board Handling	
Standard Work Area	X 410 * Y 450
No. of Valves	Single valve configuration
Maximum Loading at Z axis	~ 10 Kg (~ 22 lb)
Maximum Speed (X-Y)	200 mm/s
Repeatability	± 0.1 mm (± 0.0039")
Maximum Components Height	160 mm (6.29") from PCB
PCB Edge Clearance	≥ 5 mm (≥ 0.19")
Maximum Conveyor Width	450 mm (17.7")
Minimum Conveyor Width	50 mm (1.97")
Maximum Conveyor loading	20 Kg (44 lb)
Transmission system	
Process Flow	L to R (Standard), R to L (Optional)
Conveyor Height	900 ± 20 mm (35.43" ± 0.79")
Conveyor Speed (XY)	2 - 13 m/min
Conveyor Width Adjustment	Automatic (motorized)
Facility	
Standard Footprint	L 1010 x W 1395 x H 1749 mm (L 39.76" x W 54.92" x H 68.85")
Weight	670 Kg (1474 lb)
Air Requirement	0.6 Mpa
Input Power	AC 220 V 50/60 Hz
Total Power	2.2 KW
Interface	
Controller	IPC and motion control card
Software	Anda user interface software with Windows
Programming	Keyboard & mouse mode
Communications Protocol	SMEMA

Standard Features

- Single valve configuration in the standard machine
- Auto dipping and purging waste collection system
- LED UV lamps for inspection
- PCB clamping system
- UPS and voltage stabilizer
- ESD grounding point
- CE certified

Optional Features

- CCD vision camera
- Barcode or 2D code scanning system
- Variable size of mixing tube (< 300 mm)
- Pallet return conveyor (Underneath)
- MES uploading system

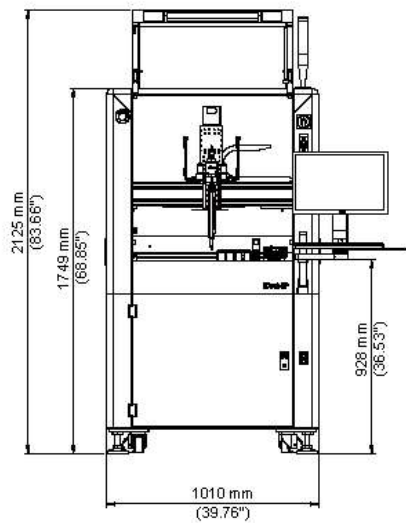

Front View

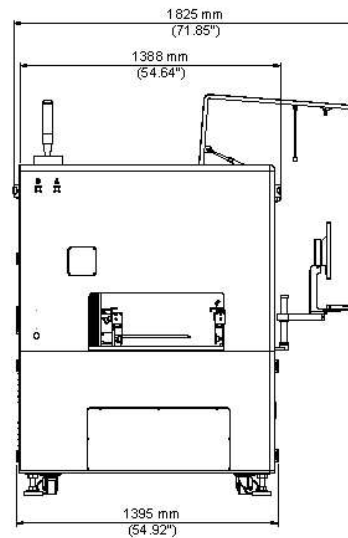

Side View