



**PROCESS SOLUTIONS
YOU CAN COUNT ON**

iCoat-6 SERIES

HIGH PRECISION SELECTIVE CONFORMAL COATING MACHINE
WITH CLOSED LOOP FLUID HEATING SYSTEM

Features & Benefits

- Application for thin film valve, high precision coating process achieving clear spraying boundary, no saw tooth and no spatter
- Closed loop fluid circulation and heater provide a constant temperature control to guarantee the set fluid viscosity and avoid the bubble, and to provide the best coating quality
- Mounted over conveyor exit or x-axis for coating result check

Product Description

Dual head configurations with fixed valves separation are available for iCoat-6 the high precision selective conformal coating machine with closed loop fluid heating system which provides a constant temperature control to guarantee the set fluid viscosity, even in machine suspension.

Automatic fluid pressure recovery system provides a high stability of fluid pressure to guarantee a constant fluid pressure supply even in low fluid pressure condition.

For thin film valve, a laser film width sensor provides a closed loop automatic adjustment of film width.

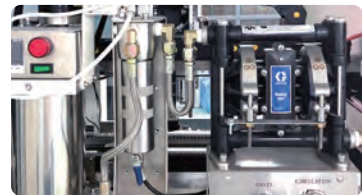

Closed loop fluid heating system



Thin film valve achieving clear spraying boundary

Specifications :

System Specifications

iCoat-6
High Precision Selective Conformal Coating Machine
with Closed Loop Fluid Heating System

Board Handling

Standard Work Area	X 360 × Y 450 × Z 100 mm (X 14.17" × Y 17.71" × Z 3.93")
Maximum Components Height	± 90 mm (± 3.54") from PCB
PCB Edge Clearance	≥ 5 mm (≥ 0.19")
Single Spray Width	2 – 30 mm (0.078" – 1.18")
Max. Conveyor Width	450 mm (17.71")
Min. Conveyor Width	50 mm (1.96")

Transmission system

Process Flow	L to R (Standard), R to L (Optional)
Conveyor Height	900 ± 20 mm (35.43" ± 0.79")
Conveyor Speed (XY)	2 – 13 m/min
Convey Width Adjustment	Automatic (motorized)

Z Axis Configuration

No. of Valves	Dual Valves configuration with fixed valves separation
Maximum Speed	800 mm/s
Repeatability	± 0.02 mm (± 0.0007")

Facility

Standard Footprint	L 900 × W 1300 × H 1675 mm (L 35.43" × W 51.18" × H 3.93")
Weight	560 kg
Motor Power	DC 24 V 69 W × 2
Air Requirement	0.4 Mpa
Exhaust Requirement	15 m ³ /min
Input Power	AC 220 V 50/60 Hz
Total Power	2.4 KW

Interface

Controller	IPC and motion control card
Software	Anda user interface software with Windows 7
Programming	Keyboard & mouse mode
Communications Protocol	SMEMA

Standard Features

- Auto dipping and purging waste collection system
- Safety door lock system
- LED UV lamps for inspection
- ESD grounding point
- CCD vision camera
- PCB clamping system
- Material level detection
- Material heating circulation system
- Material filtration system
- Low pressure fluid automatic adjustment system
- Film width laser checking system
- Diaphragm pump feeding system
- CE certified

Optional Features

- Barcode or 2D code scanning system
- UPS and voltage stabilizer
- Pallet return conveyor (Underneath)
- Programmable valve cleaner
- Track enhancement
- 3 gal. pressure drum

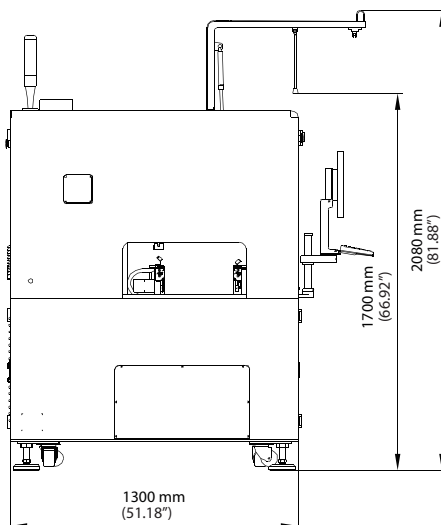

Side View

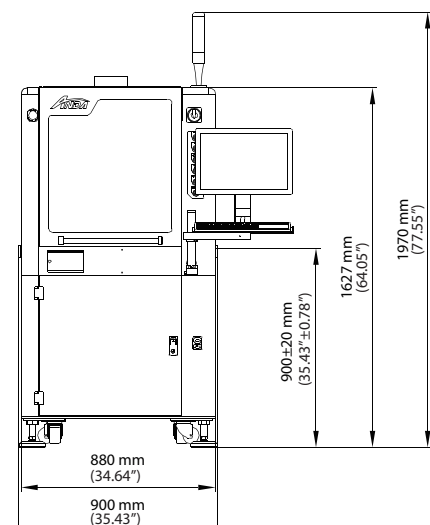

Front View